

AI

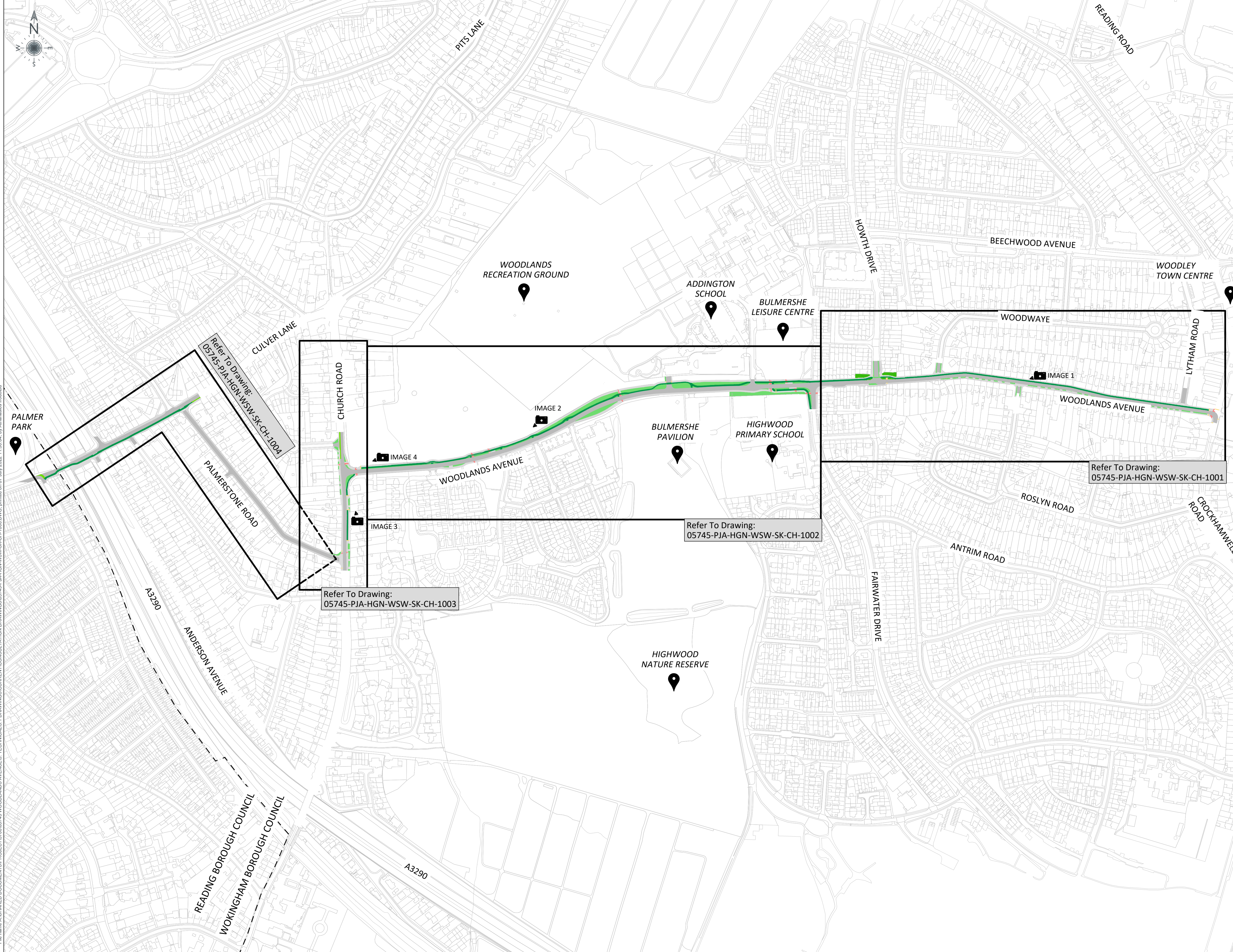

File name: A:\SHARED DOCUMENTS\PROJECTS\7000\05745 WOODLANDS AVENUES, TECHNICAL\3.1 DRAWINGS\CURRENT\CONSULTATION DRAWINGS\05745-PJA-HGN-WSW-SK-CH-1000.DWG, printed on 07 July 2022, 11:30:04, by Athanasios Iordanou

CDM NOTE

These drawings have been produced with reference to the CDM Regulations 2015. Please note that these are pre-construction phase drawings and should be subject to further design risk management as required in accordance with Regulation 9

NOTES

1. Do not scale from this drawing.
2. All dimensions in metres unless stated otherwise.
3. Design is based on Topographical Survey conducted by TGL on behalf of Wokingham Borough Council. (ref: TGL/1313/1 rev. A)
4. OS background shown indicatively.
5. Purpose of the drawing is to present a proposed cycle route connecting Woodley Town Centre and Reading.
6. For Cycle Network Design Details refer to drawings: 05745-PJA-HGN-WSW-SK-CH-1001 to 1005.
7. For Typical Cross Sections refer to drawing: 05745-PJA-HGN-WSW-SK-CH-1006

KEY

- Carriageway
- Footway
- Cycle Track
- Cycle Lane
- Verge
- Computer Generated Image Location
- Local Landmark Location

Refer To Drawing:
05745-PJA-HGN-WSW-SK-CH-1004

Refer To Drawing:
05745-PJA-HGN-WSW-SK-CH-1003

Refer To Drawing:
05745-PJA-HGN-WSW-SK-CH-1002

Refer To Drawing:
05745-PJA-HGN-WSW-SK-CH-1001

P03	04/07/2022	ISSUED FOR CONSULTATION	TI	SG	SG
P02	24/06/2022	UPDATED IN RESPONSE TO CONSULTATION	ML	TI	SG
P01	14/01/2022	ISSUED FOR CONSULTATION	TI	SG	SG
REV	DATE	REVISION NOTE	DRW	CHK	APP

FOR INFORMATION

DRAWING ISSUE STATUS

PJA

The Aquarium - King Street
Reading - RG1 2AN
Tel: 0118 956 0909

Birmingham - Bristol - Cambridge
Exeter - London
Manchester - Melbourne - Reading
pja.co.uk

CLIENT
Wokingham Borough Council

PROJECT
**Wokingham Borough Active Travel Fund
Woodley/Reading Active Travel Route**

DRAWING TITLE
Preliminary Cycle Network Design Key Plan

PJA JOB No.	SCALE	DATE
05745	NTS	07/01/2021
DRAWING NO.	REVISION	
05745-PJA-HGN-WSW-SK-CH-1000	P03	
DRAWN	CHECKED	APPROVED
TI	SG	SG

These drawings have been produced with reference to the CDM Regulations 2015. Please note that these are pre-construction phase drawings and should be subject to further design risk management as required in accordance with Regulation 9

NOTES

- Do not scale from this drawing.
- All dimensions in metres unless stated otherwise.
- Design is based on Topographical Survey conducted by TGL on behalf of Wokingham Borough Council. (ref: TGL/1313/1 rev. A)
- OS background shown indicatively.
- Highway boundary information provided by WBC and replicated on topographical survey.
- Purpose of the drawing is to present a proposed cycle route connecting Woodley Town Centre and Reading.
- The cycle-track design has been in compliance with LTN 1/20, while the proposals for the road network have been in accordance with Manual for Streets & Manual for Streets 2, therefore the design details are:
 - The minimum road width is 6.2m for bus routes
 - The minimum road width is 5.0m for non bus routes
 - The minimum cycle-track width is 2.3m
 - The minimum footway width is 2m, or retained as per the existing
 - Controlled crossings provided have a minimum width of 3m
 - Junctions along the route are to be upgraded to Copenhagen continuous crossings, prioritising pedestrian and cyclist movements
- The design has been developed with no services information, therefore it should be taken as indicative and for discussion purposes only.

KEY

- Highway Boundary
- Carriageway
- Footway
- 2-way Stepped Cycle Track (Raised 50mm above carriageway)
- 2-way Stepped Cycle Track (Raised 50mm above carriageway with additional segregation kerb)
- 1-way on-carriageway advisory cycle lane
- Verge
- Buff Tactile Paving
- Red Tactile Paving
- Hazard Warning Paving
- Double Yellow Lines
- Computer Generated Image Location

For Cross Section details refer to drawing 05745-PJA-HGN-WSW-SK-CH-1006

REV	DATE	REVISION NOTE	DRW	CHK	APP
P07	04/07/2022	ISSUED FOR CONSULTATION	TI	SG	SG
P06	01/07/2022	UPDATED IN RESPONSE TO CONSULTATION	ML	TI	SG
P05	14/01/2022	ISSUED FOR CONSULTATION	TI	SG	SG
P04	23/12/2021	PROJECT TITLE AMENDED	SG	SG	SG
P03	20/12/2021	WBC COMMENTS INCORPORATED	SG	SG	SG
P02	17/12/2021	HATCHING ADDED	TI	SG	SG
P01	26/11/2021	FIRST ISSUE	TI	SG	SG

FOR INFORMATION

PJA
The Aquarium - King Street
Reading - RG1 2AN
Tel: 018 956 0909
Birmingham - Bristol - Cambridge
Exeter - London
Manchester - Melbourne - Reading
pja.co.uk

Wokingham Borough Council

Wokingham Borough Active Travel Fund
Woodley/Reading Active Travel Route

Preliminary Active Travel Design Sheet 1 of 4

PJA JOB No.	SCALE	DATE
05745	1:500	07/01/2022
DRAWING NO.	REVISION	
05745-PJA-HGN-WSW-SK-CH-1001	P07	
DRAWN	CHECKED	APPROVED
TI	SG	SG

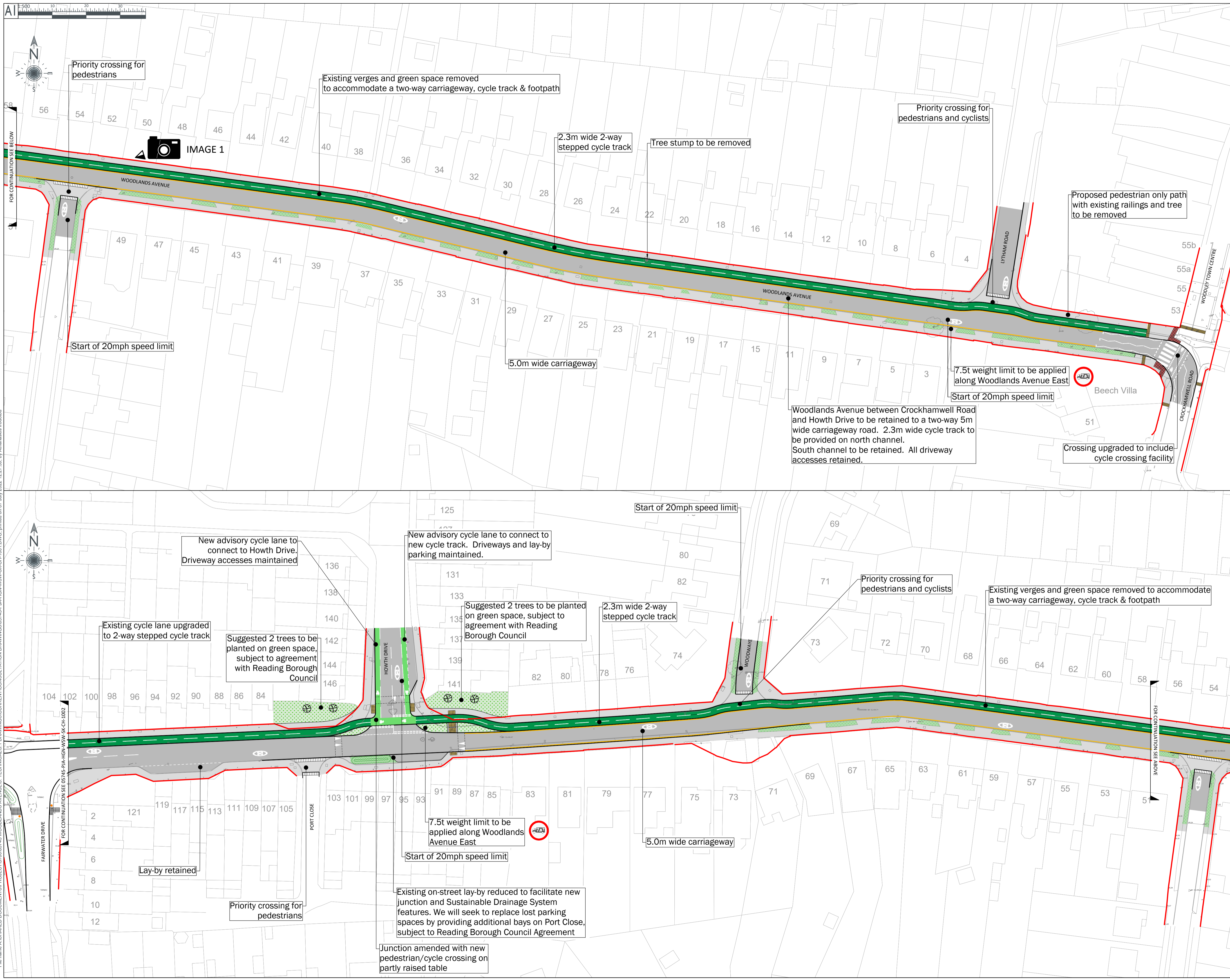

File name: A:\SHARED DOCUMENTS\PROJECTS\57000\5745 WOODLANDS AVENUE\1 DRAWINGS\CURRENT\CONSULTATION DRAWINGS\05745-PJA-HGN-WSW-SK-CH-1001.DWG, printed on 07 July 2022, 12:27:30, by Athanasios Iordanou

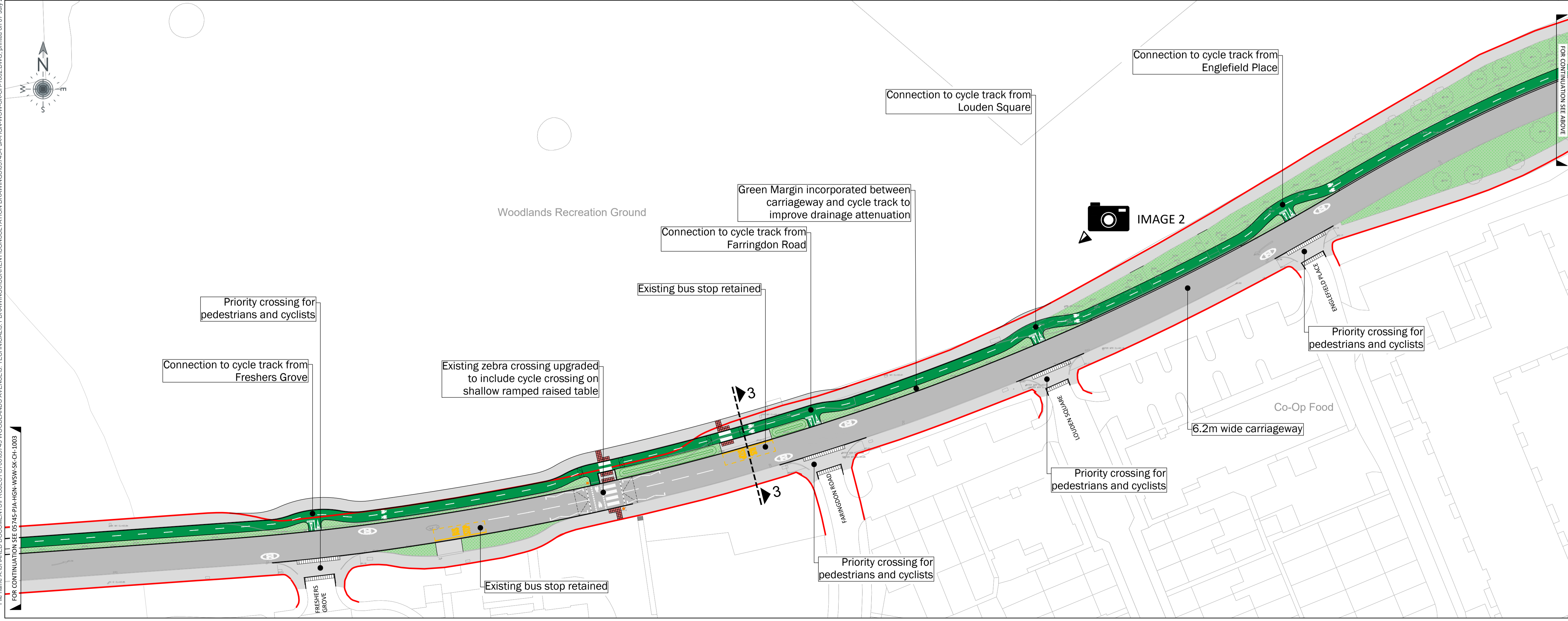
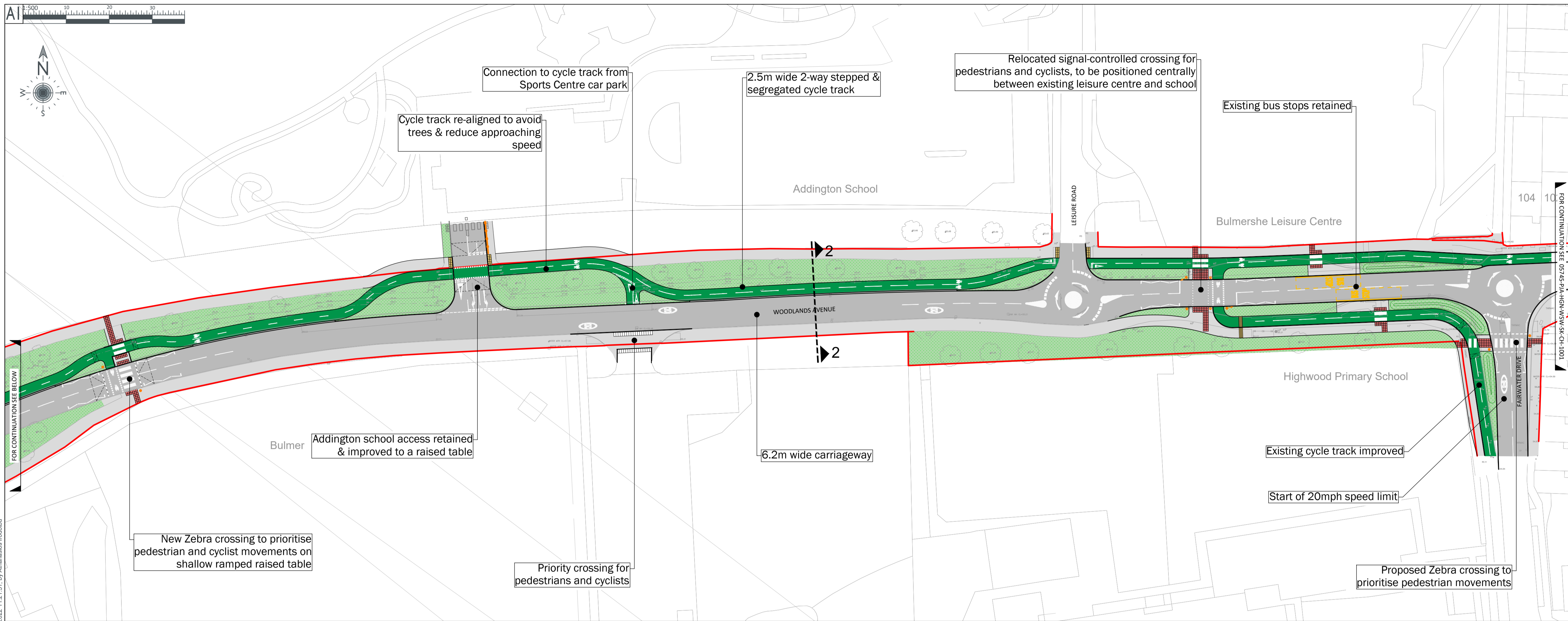
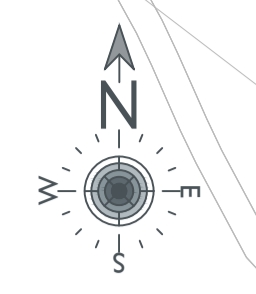
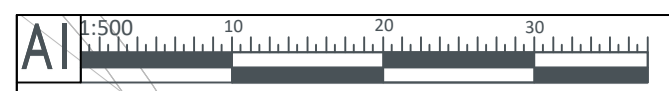

CDM NOTE

These drawings have been produced with reference to the CDM Regulations 2015. Please note that these are pre-construction phase drawings and should be subject to further design risk management as required in accordance with Regulation 9

NOTES

- Do not scale from this drawing.
- All dimensions in metres unless stated otherwise.
- Design is based on Topographical Survey conducted by TGL on behalf of Wokingham Borough Council. (ref: TGL/1313/1 rev. A)
- OS background shown indicatively.
- Highway boundary information provided by WBC and replicated on topographical survey.
- Purpose of the drawing is to present a proposed cycle route connecting Woodley Town Centre and Reading.
- The cycle-track design has been in compliance with LTN 1/20, while the proposals for the road network have been in accordance with Manual for Streets & Manual for Streets 2, therefore the design details are:
 - The minimum road width is 6.2m for bus routes
 - The minimum road width is 5.0m for non bus routes
 - The minimum cycle-track width is 2.3m
 - The minimum footway width is 2m, or retained as per the existing
 - Controlled crossings provided have a minimum width of 3m
 - Junctions along the route are to be upgraded to Copenhagen continuous crossings, prioritising pedestrian and cyclist movements
- The design has been developed with no services information, therefore it should be taken as indicative and for discussion purposes only.

KEY

- Highway Boundary
- Carriageway
- Footway
- 2-way Stepped Cycle Track (Raised 50mm above carriageway)
- 2-way Stepped Cycle Track (Raised 50mm above carriageway with additional segregation kerb)
- 1-way on-carriageway advisory cycle lane
- Verge
- Buff Tactile Paving
- Red Tactile Paving
- Hazard Warning Paving
- Pedestrian Guardrail
- Computer Generated Image Location

For Cross Section details refer to drawing 05745-PJA-HGN-WSW-SK-CH-1006

REV	DATE	REVISION NOTE	DRW	CHK	APP
P06	04/07/2022	ISSUED FOR CONSULTATION	TI	SG	SG
P05	01/07/2022	UPDATED IN RESPONSE TO CONSULTATION	ML	TI	SG
P04	18/01/2022	ISSUED FOR CONSULTATION WITH MINOR TEXT EDIT	TI	SG	SG
P03	14/01/2022	ISSUED FOR CONSULTATION	TI	SG	SG
P02	07/01/2022	PROJECT TITLE AMENDED	TI	SG	SG
P01	26/11/2021	FIRST ISSUE	TI	SG	SG

FOR INFORMATION

DRAWING ISSUE STATUS

PJA

The Aquarium - King Street
Reading - RG1 2AN
Tel: 0118 956 0909

Birmingham - Bristol - Cambridge
Exeter - London
Manchester - Melbourne - Reading
pja.co.uk

Wokingham Borough Council

Wokingham Borough Active Travel Fund
Woodley/Reading Active Travel Route

Preliminary Cycle Network Design
Sheet 2 of 4

PJA JOB No.	SCALE	DATE
05745	1:500	07/01/2021
DRAWING NO.	REVISION	
05745-PJA-HGN-WSW-SK-CH-1002	P06	
DRAWN	CHECKED	APPROVED
TI	SG	SG

File name: A:\SHARED DOCUMENTS\PROJECTS\570005745 WOODLANDS AVENUES\TECHNICAL\3 DRAWINGS\CURRENT\CONSULTATION DRAWINGS\05745-PJA-HGN-WSW-SK-CH-1002.DWG, printed on 07 July 2022, 11:21:51, by Athanasios Iordou

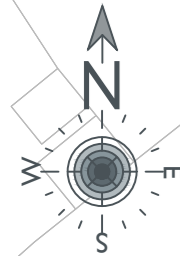

These drawings have been produced with reference to the CDM Regulations 2015. Please note that these are pre-construction phase drawings and should be subject to further design risk management as required in accordance with Regulation 9

NOTES

1. Do not scale from this drawing.
2. All dimensions in metres unless stated otherwise.
3. Design is based on Topographical Survey conducted by TGL on behalf of Wokingham Borough Council. (ref: TGL/1313/1 rev. A)
4. OS background shown indicatively.
5. Highway boundary information provided by WBC and replicated on topographical survey.
6. Purpose of the drawing is to present a proposed cycle route connecting Woodley Town Centre and Reading.
7. The cycle-track design has been in compliance with LTN 1/20, while the proposals for the road network have been in accordance with Manual for Streets & Manual for Streets 2, therefore the design details are:
 - 7.1. The minimum road width is 6.2m for bus routes
 - 7.2. The minimum road width is 5.0m for non bus routes
 - 7.3. The minimum cycle-track width is 2.5m
 - 7.4. The minimum footway width is 2m, or retained as per the existing
 - 7.5. Controlled crossings provided have a minimum width of 3m
 - 7.6. Junctions along the route are to be upgraded to Copenhagen continuous crossings, prioritising pedestrian and cyclist movements
8. The design has been developed with no services information, therefore it should be taken as indicative and for discussion purposes only.

KEY

- Highway Boundary
- Carriageway
- Footway
- 2-way Stepped Cycle Track (Raised 50mm above carriageway)
- 2-way Stepped Cycle Track (Raised 50mm above carriageway with additional segregation kerb)
- 1-way on-carriageway advisory cycle lane
- Verge
- Buff Tactile Paving
- Red Tactile Paving
- Hazard Warning Paving

- Computer Generated Image Location
- For Cross Section details refer to drawing 05745-PJA-HGN-WSW-SK-CH-1006

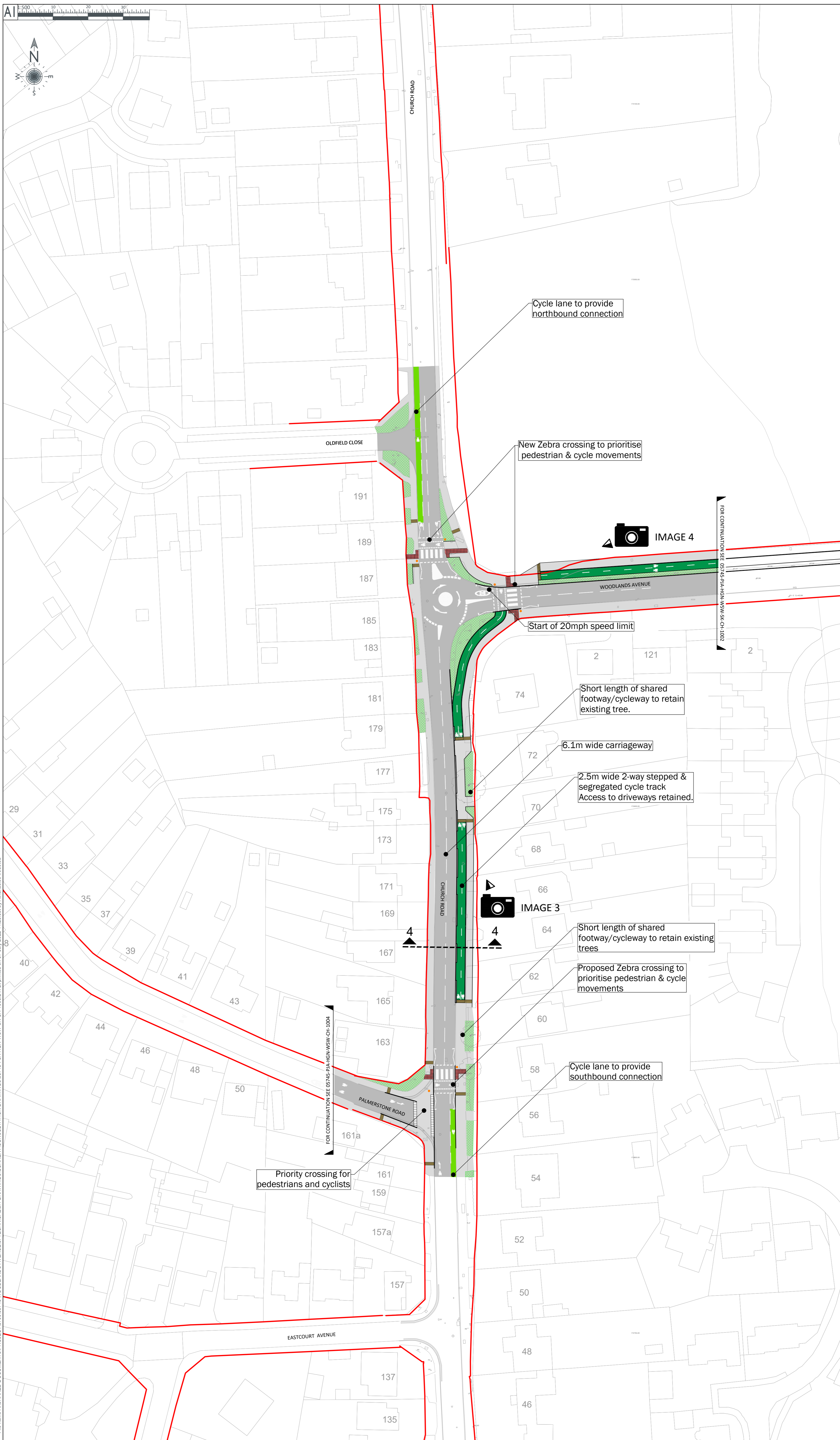

REV	DATE	REVISION NOTE	DRW	CHK	APP
P05	04/07/2022	ISSUED FOR CONSULTATION	TI	SG	SG
P04	01/07/2022	UPDATED IN RESPONSE TO CONSULTATION	ML	TI	SG
P03	14/01/2022	ISSUED FOR CONSULTATION	TI	SG	SG
P02	07/01/2021	PROJECT TITLE AMENDED	TI	SG	SG
P01	26/11/2021	FIRST ISSUE	TI	SG	SG

FOR INFORMATION

DRAWING ISSUE STATUS

The Aquarium - King Street
Reading - RG1 2AN
Tel: 0118 956 0909

Birmingham - Bristol - Cambridge
Exeter - London
Manchester - Melbourne - Reading
pja.co.uk

CLIENT

Wokingham Borough Council

PROJECT

Wokingham Borough Active Travel Fund
Woodley/Reading Active Travel Route

DRAWING TITLE

Preliminary Cycle Network Design
Sheet 3 of 4

PJA JOB No. 05745
SCALE 1:500
DATE 07/01/2021

DRAWING NO. 05745-PJA-HGN-WSW-SK-CH-1003
REVISION P05

DRAWN TI
CHECKED SG
APPROVED SG

File name: A:\SHARED_DOCUMENTS\PROJECTS\05745-PJA-HGN-WSW-SK-CH-1003.DWG, printed on 07 July 2022 11:23:50, by Albaniasas.trodobol

These drawings have been produced with reference to the CDM Regulations 2015. Please note that these are pre-construction phase drawings and should be subject to further design risk management as required in accordance with Regulation 9

NOTES

- Do not scale from this drawing.
- All dimensions in metres unless stated otherwise.
- Design is based on Topographical Survey conducted by TGL on behalf of Wokingham Borough Council. (ref: TGL/1313/1 rev. A)
- OS background shown indicatively.
- Highway boundary information provided by WBC and replicated on topographical survey.
- Purpose of the drawing is to present a proposed cycle route connecting Woodley Town Centre and Reading.
- The cycle-track design has been in compliance with LTN 1/20, while the proposals for the road network have been in accordance with Manual for Streets & Manual for Streets 2, therefore the design details are:
 - The minimum road width is 6.2m for bus routes
 - The minimum road width is 5.0m for non bus routes
 - The minimum cycle-track width is 2.3m
 - The minimum footway width is 2m, or retained as per the existing
 - Controlled crossings provided have a minimum width of 3m
 - Junctions along the route are to be upgraded to Copenhagen continuous crossings, prioritising pedestrian and cyclist movements.
- The design has been developed with no services information, therefore it should be taken as indicative and for discussion purposes only.

KEY

- Highway Boundary
 - Carriageway
 - Footway
 - 2-way Stepped Cycle Track (Raised 50mm above carriageway)
 - 2-way Stepped Cycle Track (Raised 50mm above carriageway with additional segregation kerb)
 - Buff Tactile Paving
 - Red Tactile Paving
 - Hazard Warning Paving
 - Double Yellow Lines
- For Cross Section details refer to drawing 05745-PJA-HGN-WSW-SK-CH-1006

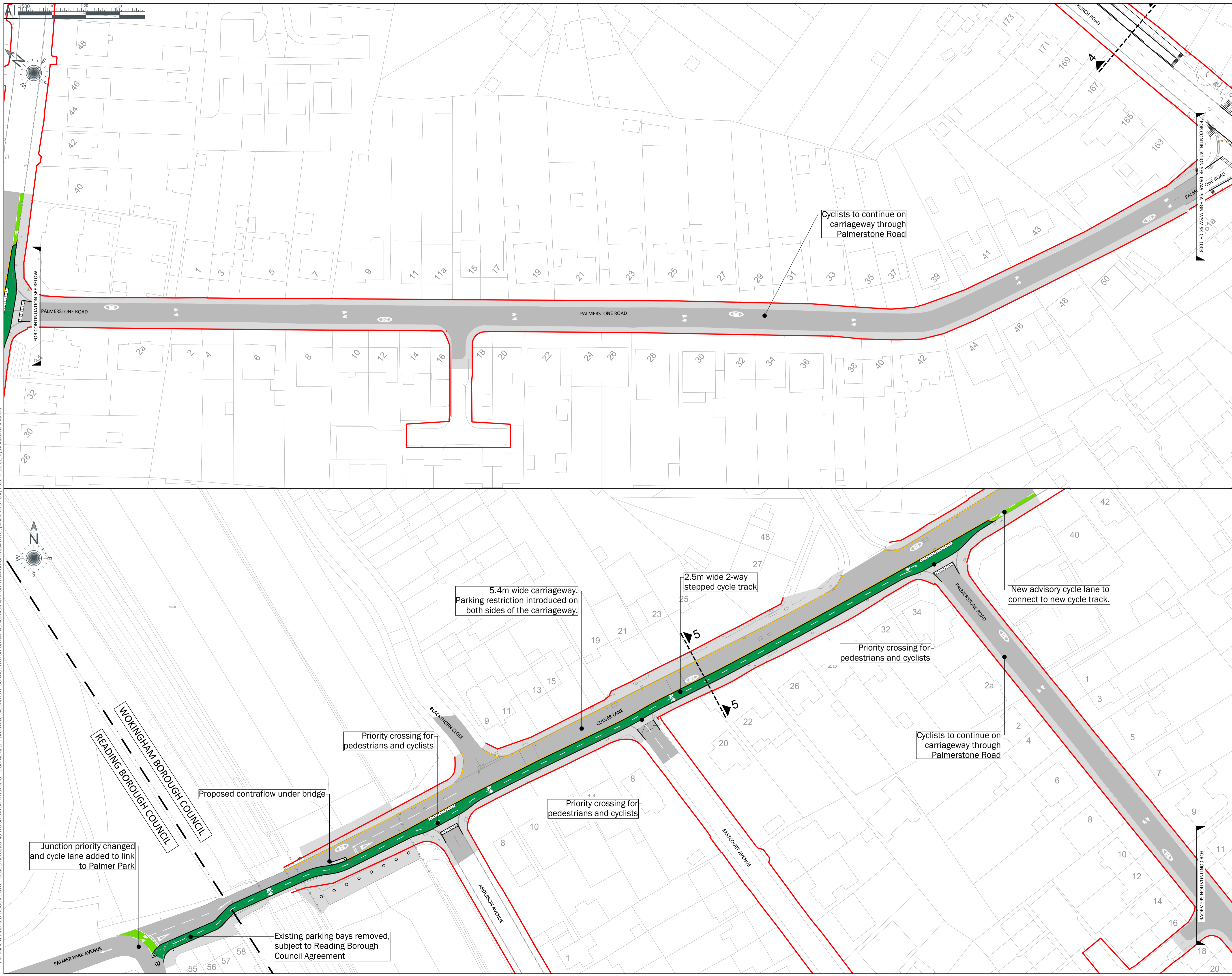

REV	DATE	REVISION NOTE	DRW	CHK	APP
P06	04/07/2022	ISSUED FOR CONSULTATION	TI	SG	SG
P05	01/07/2022	UPDATED IN RESPONSE TO CONSULTATION	ML	TI	SG
P04	18/01/2022	ISSUED FOR CONSULTATION WITH MINOR TEXT EDITS	TI	SG	SG
P03	14/01/2022	ISSUED FOR CONSULTATION	TI	SG	SG
P02	07/01/2021	PROJECT TITLE AMENDED	TI	SG	SG
P01	26/11/2021	FIRST ISSUE	TI	SG	SG

FOR INFORMATION

DRAWING ISSUE STATUS

The Aquarium - King Street
Reading - RG1 2AN
Tel: 0118 956 0909
Birmingham - Bristol - Cambridge
Exeter - London
Manchester - Melbourne - Reading
pja.co.uk

CLIENT
Wokingham Borough Council

PROJECT
Wokingham Borough Active Travel Fund
Woodley/Reading Active Travel Route

DRAWING TITLE
Preliminary Cycle Network Design
Sheet 4 of 4

PJA JOB No.	SCALE	DATE
05745	1:500	07/01/2021
DRAWING NO.	REVISION	
05745-PJA-HGN-WSW-SK-CH-1004	P06	
DRAWN	CHECKED	APPROVED
TI	SG	SG

File name: A:\SHARED DOCUMENTS\PROJECTS\570005745 WOODLANDS AVENUES\3. TECHNICAL\3.1 DRAWINGS\CURRENT\CONSULTATION DRAWINGS\05745-PJA-HGN-WSW-SK-CH-1004.DWG, printed on 07 July 2022, 11:25:02, by Athanasios Iordanou

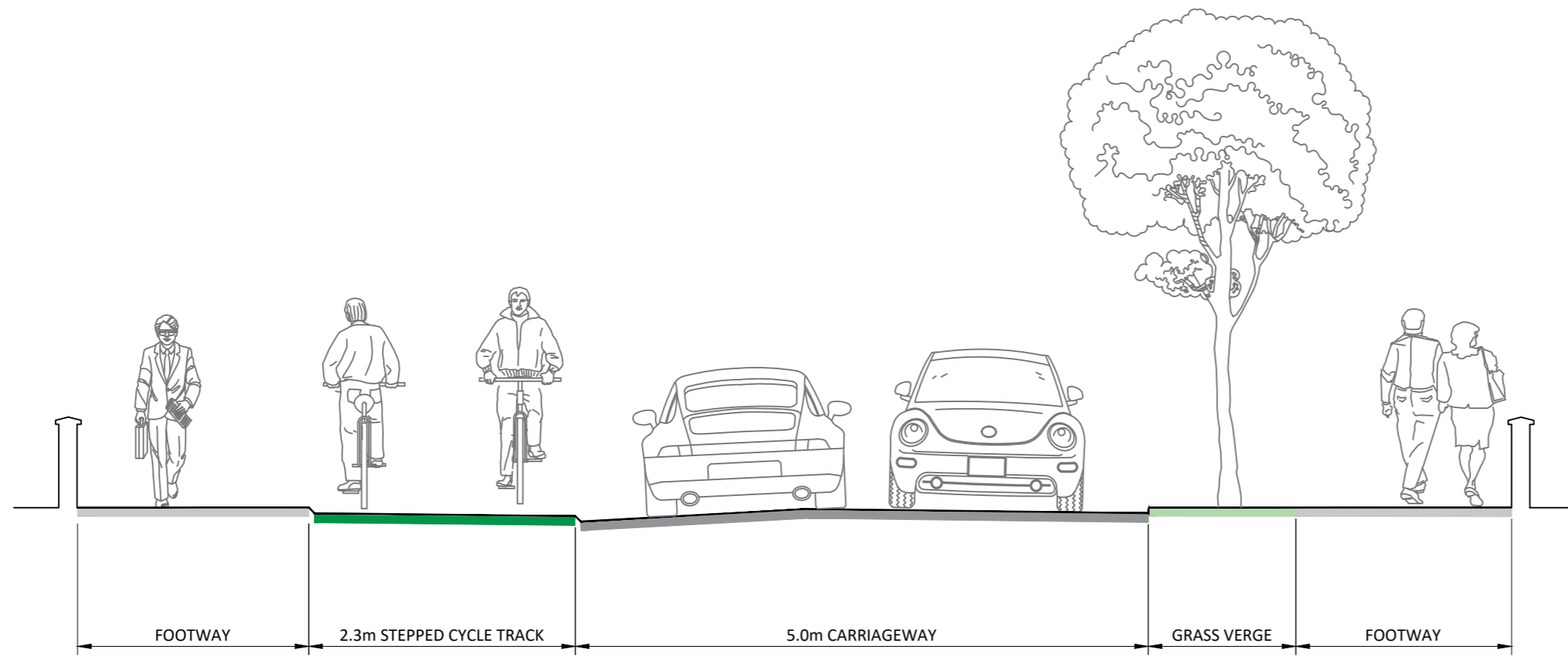

SECTION 1 - WOODLANDS AVENUE - LOOKING EAST

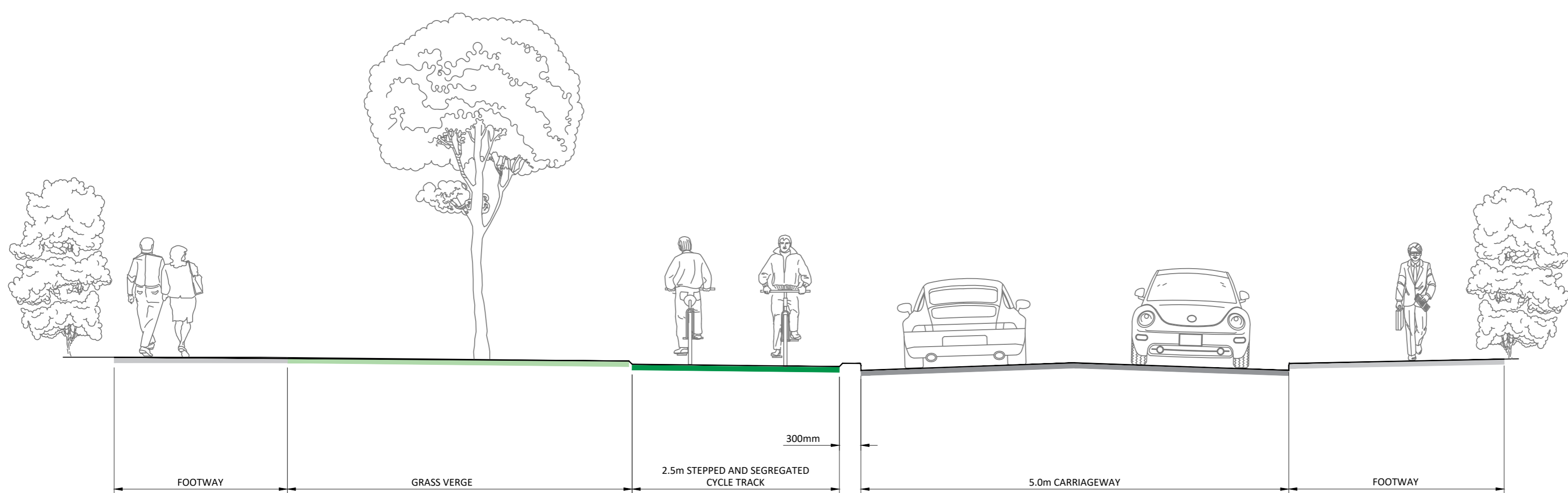

SECTION 2 - WOODLANDS AVENUE - LOOKING EAST

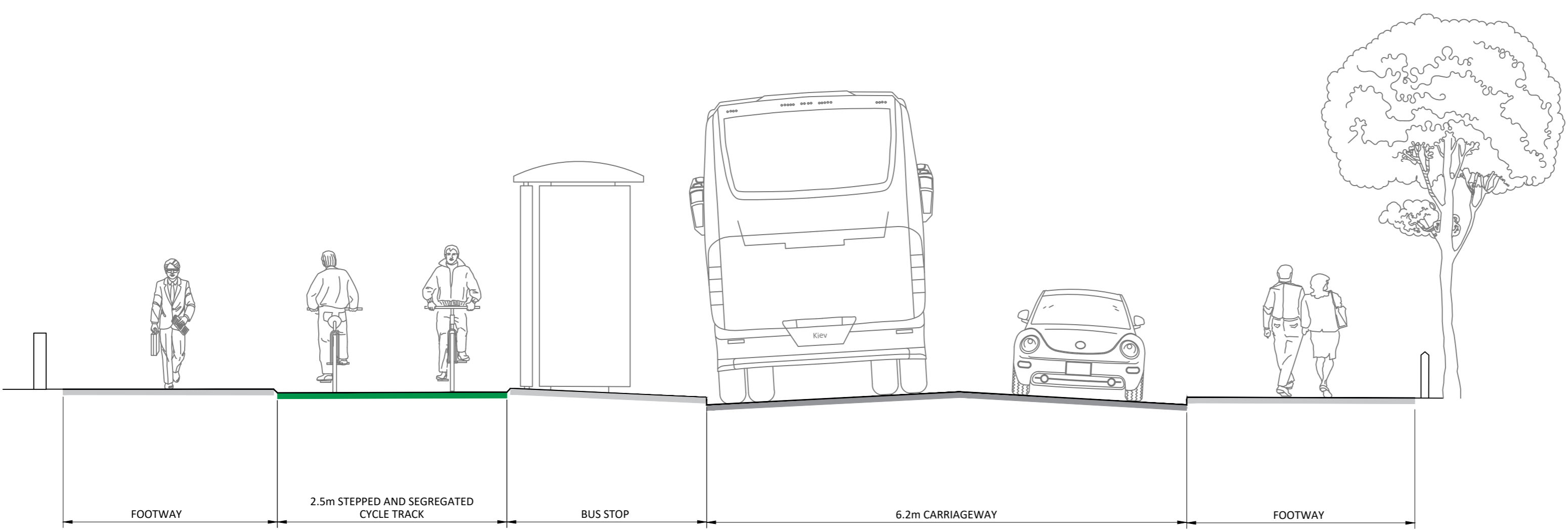

SECTION 3 - WOODLANDS AVENUE - LOOKING EAST

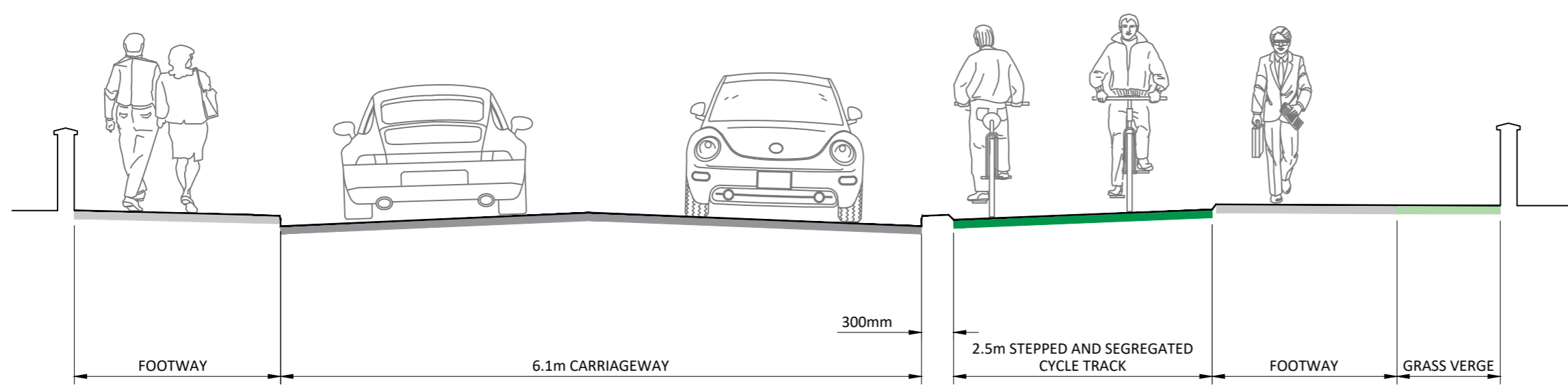

SECTION 4 - CHURCH ROAD - LOOKING NORTH

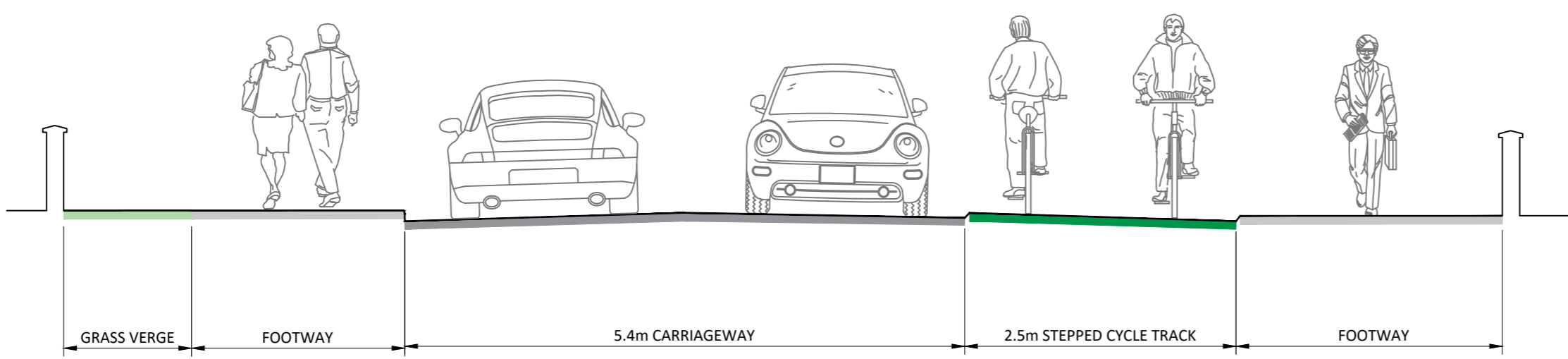

SECTION 5 - CULVER LANE - LOOKING EAST

- NOTES**
1. All dimensions in metres unless otherwise stated.
 2. Do not scale from this drawing.
 3. To be read in conjunction with all relevant engineering drawings and documentation.
 4. Typical cross sections are shown indicatively and are not part of construction details.
 5. For cross section location refers to drawings 05745-PJA-HGN-WSW-SK-CH-1001 to 1004

REV	DATE	REVISION NOTE	DRW	CHK	APP
P03	04/07/2022	ISSUED FOR CONSULTATION	TI	SG	SG
P02	30/06/2022	UPDATED IN RESPONSE TO CONSULTATION	TI	SG	SG
P01	14/01/2022	FIRST ISSUE	ML	SG	SG

FOR INFORMATION

DRAWING ISSUE STATUS:

The Aquarium - King Street
 Reading - RG1 2AN
 Tel: 0118 956 0909
 Birmingham - Bristol - Cambridge
 Exeter - London
 Manchester - Melbourne - Reading
 pja.co.uk

CLIENT
Wokingham Borough Council

PROJECT
**Wokingham Borough Active Travel Fund
 Woodley/Reading Active Travel Route**

DRAWING TITLE
**Preliminary Cycle Network Design
 Typical Cross Sections**

PJA JOB No.	SCALE	DATE
05745	1:50	07/01/22
DRAWING NO.	REVISION	
05745-PJA-HGN-WSW-SK-CH-1006	P03	
DRAWN	CHECKED	APPROVED
ML	TI	SG

File name: A:\SHARED DOCUMENTS\PROJECTS\05745 WOODLANDS AVENUES TECHNICALS\DRAWINGS\CURRENT\CONSULTATION DRAWINGS\05745-PJA-HGN-WSW-SK-CH-1006.DWG, printed on 04 July 2022 14:22:27, by Athanasios Iodotou