

These drawings have been produced with reference to the CDM Regulations 2015. Please note that these are pre-construction phase drawings and should be subject to further design risk management as required in accordance with Regulation 9

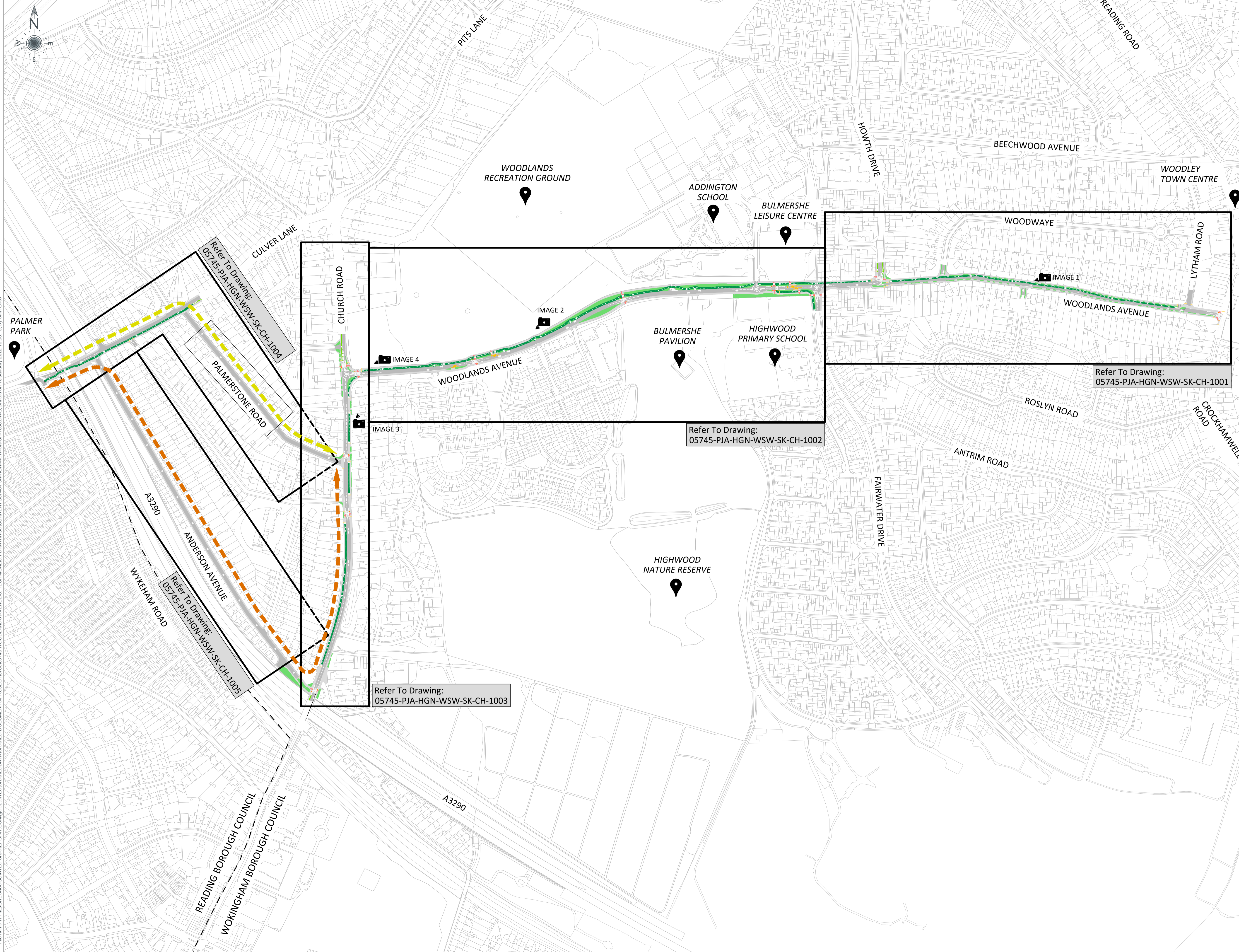

NOTES

1. Do not scale from this drawing.
2. All dimensions in metres unless stated otherwise.
3. Design is based on Topographical Survey conducted by TGL on behalf of Wokingham Borough Council. (ref: TGL/1313/1 rev. A)
4. OS background shown indicatively.
5. Purpose of the drawing is to present a proposed cycle route connecting Woodley Town Centre and Reading.
6. For Cycle Network Design Details refer to drawings: 05745-PJA-HGN-WSW-SK-CH-1001 to 1005.
7. For Typical Cross Sections refer to drawing: 05745-PJA-HGN-WSW-SK-CH-1006

KEY

- Carriageway
- Footway
- Cycle Track
- Cycle Lane
- Verge
- Computer Generated Image Location
- Local Landmark Location
- Route option 1 via Palmerstone Road/Culver Lane
- Route Option 2 via Church Road, Anderson Avenue, Culver Lane

File name: \\PHILION\ASSOCIATES\SHAREPOINT\COM\SS\LISTES\SHARED\DATA\SHARED DOCUMENTS\PROJECTS\05745-PJA-HGN-WSW-SK-CH-1000.DWG, printed on: 16 January 2022 19:58:18, by Sam Coles

Refer To Drawing: 05745-PJA-HGN-WSW-SK-CH-1004

Refer To Drawing: 05745-PJA-HGN-WSW-SK-CH-1005

Refer To Drawing: 05745-PJA-HGN-WSW-SK-CH-1002

Refer To Drawing: 05745-PJA-HGN-WSW-SK-CH-1001

Refer To Drawing: 05745-PJA-HGN-WSW-SK-CH-1003

REV	DATE	ISSUED FOR CONSULTATION	TI

FOR INFORMATION

DRAWING ISSUE STATUS



The Aquarium - King Street  
Reading - RG1 2AN  
Tel: 0118 956 0909

Birmingham - Bristol - Cambridge  
Exeter - London  
Manchester - Melbourne - Reading  
pja.co.uk

CLIENT: Wokingham Borough Council

PROJECT: Wokingham Borough Active Travel Fund  
Woodley/Reading Active Travel Route

DRAWING TITLE: Preliminary Cycle Network Design Key Plan

PJA JOB No.	SCALE	DATE
05745	NTS	07/01/2021
DRAWING NO.	REVISION	
05745-PJA-HGN-WSW-SK-CH-1000	P01	
DRAWN	CHECKED	APPROVED
TI	SG	SG